

SEMiX302GB176HDs



SEMiX® 2s

Trench IGBT Modules

SEMiX302GB176HDs

Features

- Homogeneous Si
- Trench = Trenchgate technology
- $V_{CE(sat)}$ with positive temperature coefficient
- UL recognised file no. E63532

Typical Applications*

- AC inverter drives
- UPS
- Electronic welders

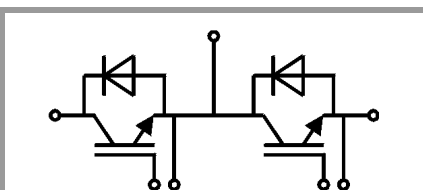

GB

Absolute Maximum Ratings				
Symbol	Conditions	Values	Unit	
IGBT				
V_{CES}		1700	V	
I_C	$T_j = 150\text{ °C}$	$T_c = 25\text{ °C}$	308	A
		$T_c = 80\text{ °C}$	219	A
I_{Cnom}		200	A	
I_{CRM}	$I_{CRM} = 2 \times I_{Cnom}$	400	A	
V_{GES}		-20 ... 20	V	
t_{psc}	$V_{CC} = 1000\text{ V}$	$T_j = 125\text{ °C}$	10	μs
	$V_{GE} \leq 20\text{ V}$			
	$V_{CES} \leq 1700\text{ V}$			
T_j		-55 ... 150	$^{\circ}\text{C}$	
Inverse diode				
I_F	$T_j = 150\text{ °C}$	$T_c = 25\text{ °C}$	389	A
		$T_c = 80\text{ °C}$	262	A
I_{Fnom}		200	A	
I_{FRM}	$I_{FRM} = 2 \times I_{Fnom}$	400	A	
I_{FSM}	$t_p = 10\text{ ms, sin } 180^{\circ}, T_j = 25\text{ °C}$	2000	A	
T_j		-40 ... 150	$^{\circ}\text{C}$	
Module				
$I_{t(RMS)}$	$T_{terminal} = 80\text{ °C}$	600	A	
T_{stg}		-40 ... 125	$^{\circ}\text{C}$	
V_{isol}	AC sinus 50Hz, $t = 1\text{ min}$	4000	V	

Characteristics					
Symbol	Conditions	min.	typ.	max.	Unit
IGBT					
$V_{CE(sat)}$	$I_C = 200\text{ A}$ $V_{GE} = 15\text{ V}$ chipelevel	$T_j = 25\text{ °C}$	2	2.45	V
		$T_j = 125\text{ °C}$	2.5	2.9	V
V_{CE0}		$T_j = 25\text{ °C}$	1	1.2	V
		$T_j = 125\text{ °C}$	0.9	1.1	V
r_{CE}	$V_{GE} = 15\text{ V}$	$T_j = 25\text{ °C}$	5.0	6.3	$\text{m}\Omega$
		$T_j = 125\text{ °C}$	7.8	9.0	$\text{m}\Omega$
$V_{GE(th)}$	$V_{GE} = V_{CE}, I_C = 8\text{ mA}$	5.2	5.8	6.4	V
I_{CES}	$V_{GE} = 0\text{ V}$ $V_{CE} = 1700\text{ V}$	$T_j = 25\text{ °C}$	0.1	3	mA
		$T_j = 125\text{ °C}$			mA
C_{ies}	$V_{CE} = 25\text{ V}$		17.6		nF
C_{oes}	$V_{GE} = 0\text{ V}$		0.73		nF
C_{res}			0.58		nF
Q_G	$V_{GE} = -8\text{ V...} + 15\text{ V}$		1866		nC
R_{Gint}	$T_j = 25\text{ °C}$		3.75		Ω
$t_{d(on)}$	$V_{CC} = 1200\text{ V}$ $I_C = 200\text{ A}$	$T_j = 125\text{ °C}$	225		ns
t_r	$V_{GE} = \pm 15\text{ V}$	$T_j = 125\text{ °C}$	45		ns
E_{on}	$R_{Gon} = 6.5\text{ }\Omega$	$T_j = 125\text{ °C}$	130		mJ
$t_{d(off)}$	$R_{Goff} = 6.5\text{ }\Omega$	$T_j = 125\text{ °C}$	665		ns
t_f		$T_j = 125\text{ °C}$	105		ns
E_{off}		$T_j = 125\text{ °C}$	77		mJ
$R_{th(j-c)}$	per IGBT			0.1	K/W

SEMiX302GB176HDs



SEMiX® 2s

Trench IGBT Modules

SEMiX302GB176HDs

Features

- Homogeneous Si
- Trench = Trenchgate technology
- $V_{CE(sat)}$ with positive temperature coefficient
- UL recognised file no. E63532

Typical Applications*

- AC inverter drives
- UPS
- Electronic welders

Characteristics						
Symbol	Conditions		min.	typ.	max.	Unit
Inverse diode						
$V_F = V_{EC}$	$I_F = 200\text{ A}$ $V_{GE} = 0\text{ V}$ chip	$T_j = 25\text{ °C}$		1.5	1.70	V
		$T_j = 125\text{ °C}$		1.4	1.6	V
V_{F0}		$T_j = 25\text{ °C}$	0.9	1.1	1.3	V
		$T_j = 125\text{ °C}$	0.7	0.9	1.1	V
r_F		$T_j = 25\text{ °C}$	2.0	2.0	2.0	mΩ
		$T_j = 125\text{ °C}$	2.7	2.7	2.7	mΩ
I_{RRM}	$I_F = 200\text{ A}$	$T_j = 125\text{ °C}$		235		A
Q_{rr}	$di/dt_{off} = 3100\text{ A}/\mu\text{s}$	$T_j = 125\text{ °C}$		77		μC
E_{rr}	$V_{GE} = -15\text{ V}$ $V_{CC} = 1200\text{ V}$	$T_j = 125\text{ °C}$		43		mJ
$R_{th(j-c)}$	per diode				0.15	K/W
Module						
L_{CE}				18		nH
$R_{CC'+EE'}$	res., terminal-chip	$T_C = 25\text{ °C}$		0.7		mΩ
		$T_C = 125\text{ °C}$		1		mΩ
$R_{th(c-s)}$	per module			0.045		K/W
M_s	to heat sink (M5)		3		5	Nm
M_t		to terminals (M6)	2.5		5	Nm
						Nm
w					250	g
Temperatur Sensor						
R_{100}	$T_c = 100\text{ °C}$ ($R_{25} = 5\text{ k}\Omega$)			$493 \pm 5\%$		Ω
$B_{100/125}$	$R(T) = R_{100} \exp[B_{100/125}(1/T - 1/T_{100})]$; T[K];			$3550 \pm 2\%$		K

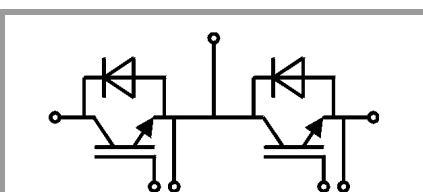

GB

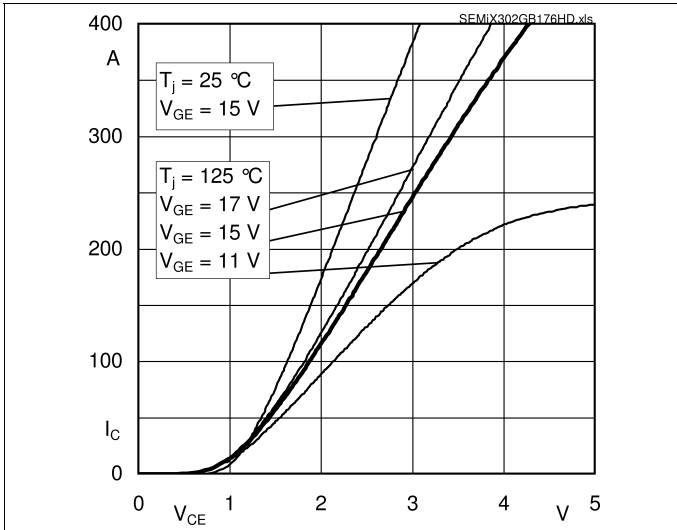

Fig. 1: Typ. output characteristic, inclusive R_{CC+EE}

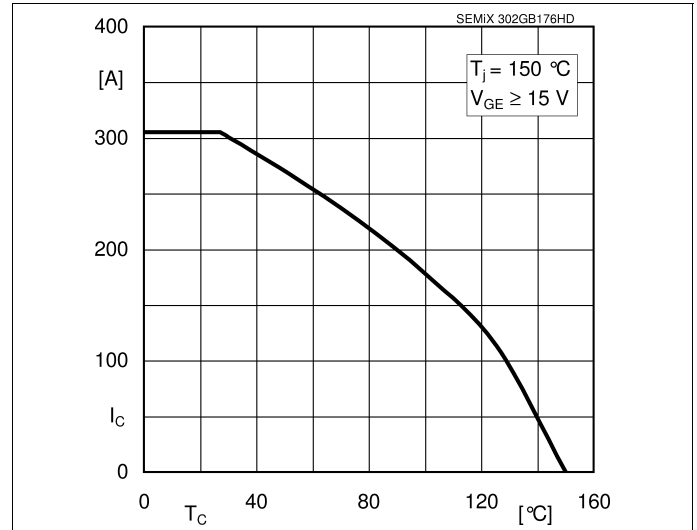

Fig. 2: Rated current vs. temperature $I_C = f(T_C)$

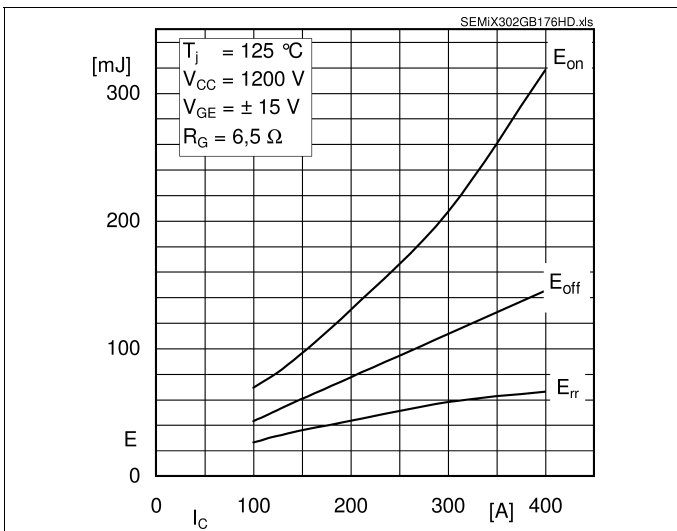

Fig. 3: Typ. turn-on /-off energy = $f(I_C)$

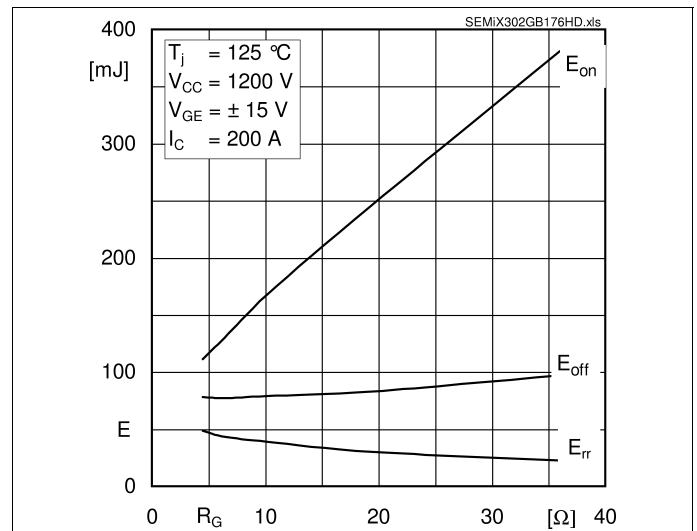

Fig. 4: Typ. turn-on /-off energy = $f(R_G)$

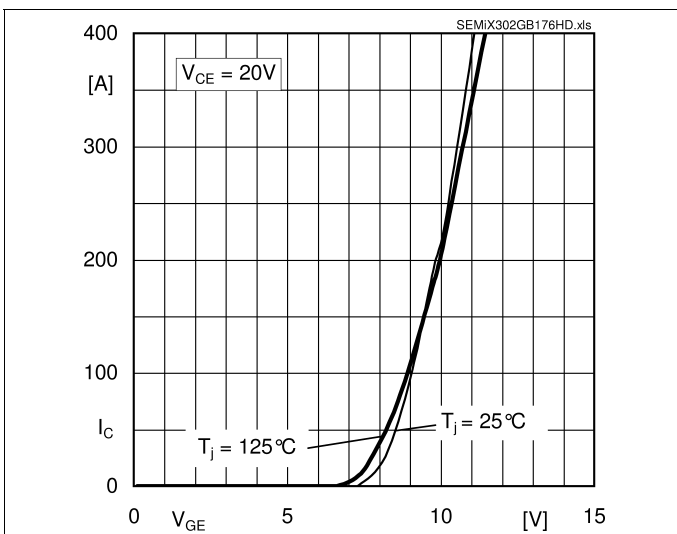

Fig. 5: Typ. transfer characteristic

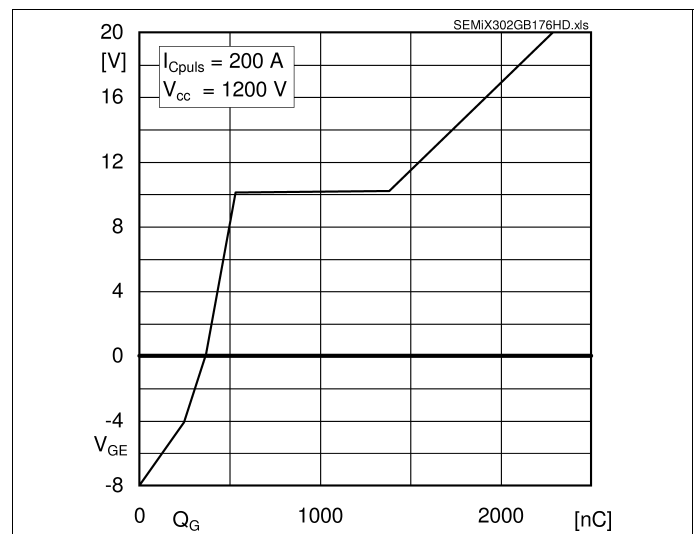
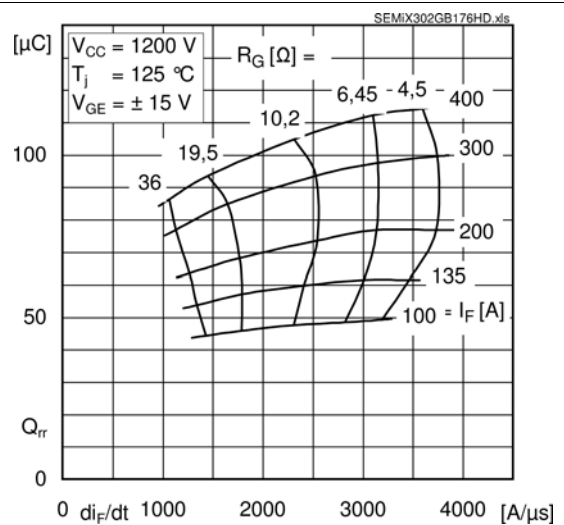
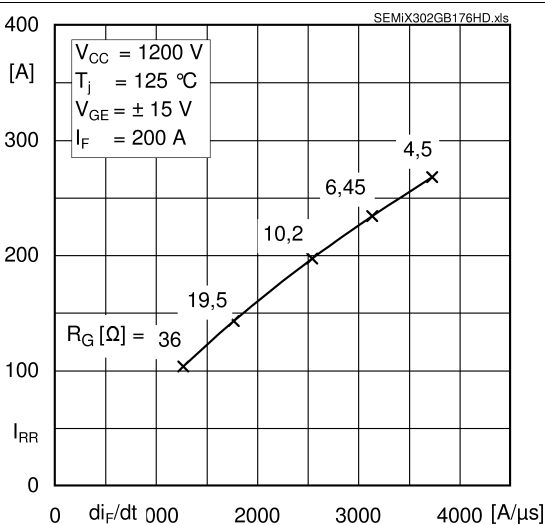
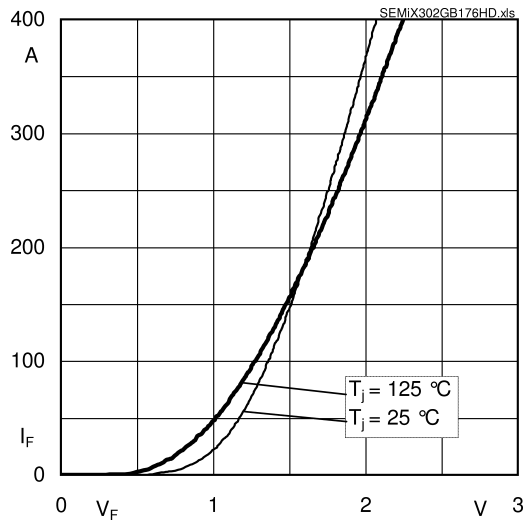
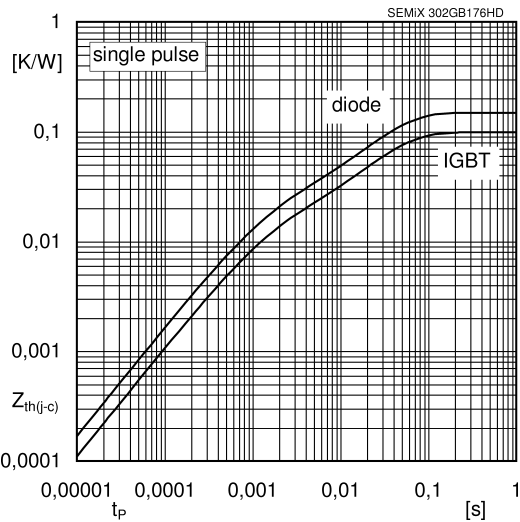
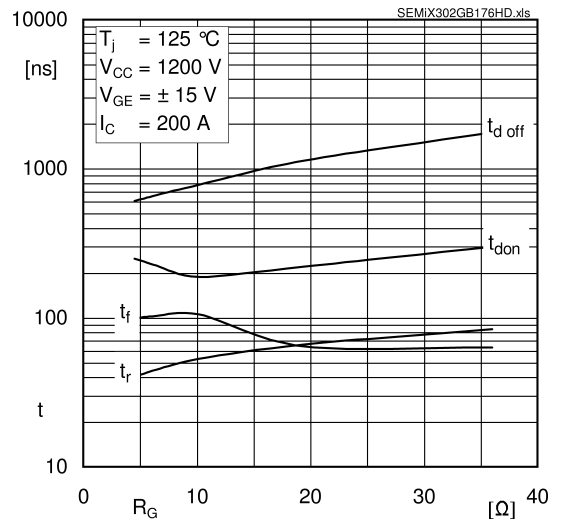
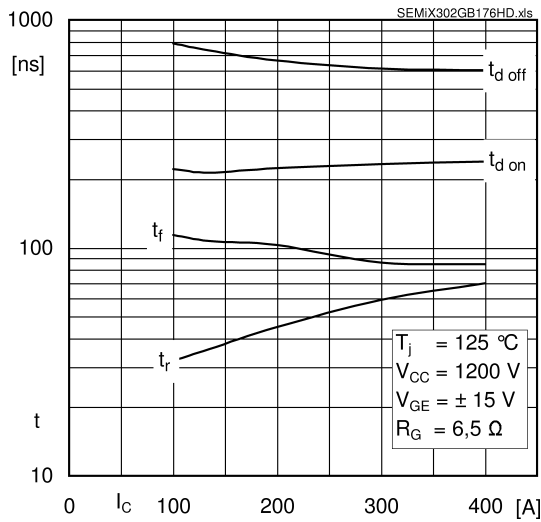

Fig. 6: Typ. gate charge characteristic



SEMiX302GB176HDs

Case: SEMiX 2s

screw duct
(left top) :
F-F (1:1)

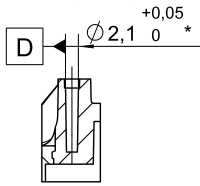

screw duct (4x)
spring duct (12x) :
G-G (1:1)

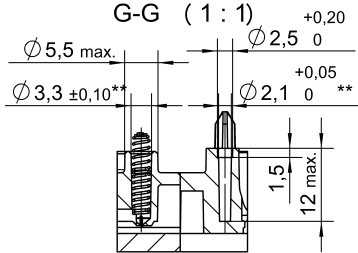

	0,3	connector 1-2 / 3-4
	0,2	each connector A

general tolerance:
ISO 2768-mK
ISO 8015

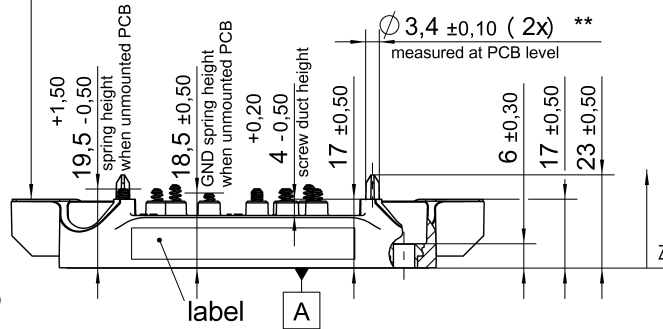

All measures in Z-direction
valid when mounted to heat sink

marking of terminals

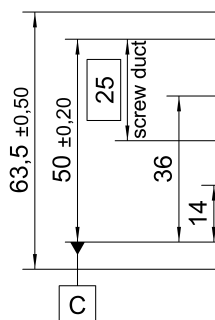

screw duct
top view (4x) :
J (2:1)

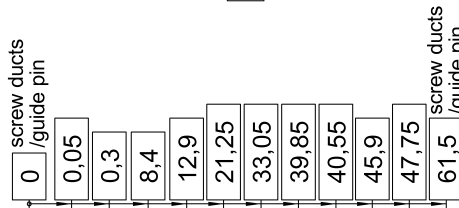
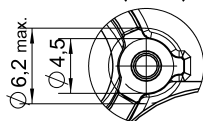

marking of terminals

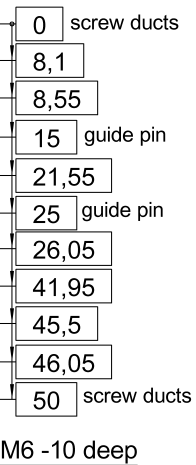

*screw duct left / top with

\oplus	ϕ 0,2	A	B	C
----------	------------	---	---	---

**screw ducts / guide pins / spring ducts with

\oplus	ϕ 0,2	A	D	C
----------	------------	---	---	---

Rules for the contact PCB:

- holes guidepins = ϕ 4 ± 0,1 / position tolerance ± 0,1
- holes for screws = ϕ 2,9 ± 0,1 / position tolerance ± 0,1
- spring contact pad = ϕ 3,6 ± 0,1 / position tolerance ± 0,1

SEMiX 2s

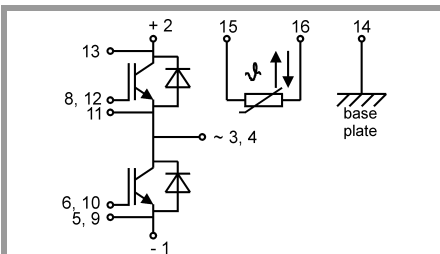

spring configuration

This is an electrostatic discharge sensitive device (ESDS), international standard IEC 60747-1, Chapter IX

* The specifications of our components may not be considered as an assurance of component characteristics. Components have to be tested for the respective application. Adjustments may be necessary. The use of SEMIKRON products in life support appliances and systems is subject to prior specification and written approval by SEMIKRON. We therefore strongly recommend prior consultation of our staff.